

# INSTALLATION & MAINTENANCE INSTRUCTIONS

## RETRIEVER REELS

### INSTALLATION

To minimize wear on cable and cable guide, reel should be mounted in direct line with work so that cable is pulled out as straight as possible during use. Reels are available in two mounting types: (A) with pull parallel to mounting surface. (B) with pull perpendicular to mounting surface. See figures 1 & 2. Choose type which provides payout in most direct line to attachment. In addition, mount reel so that axis is perpendicular to most common payout. See figures 3 & 4.

1. Mount reel to firm, secure surface using four holes in mounting base.

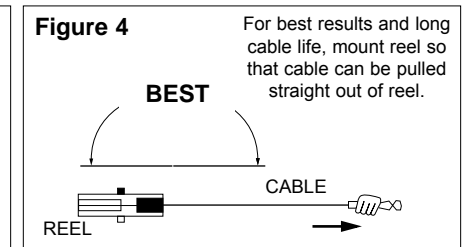
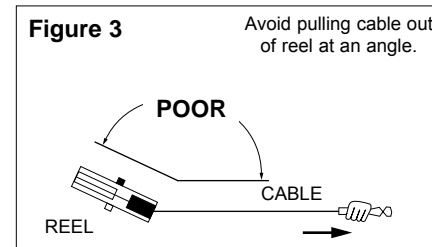
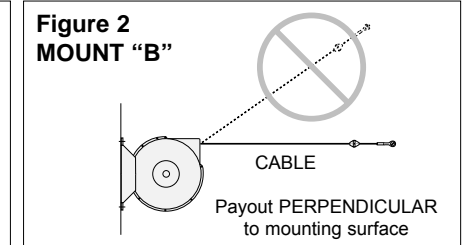
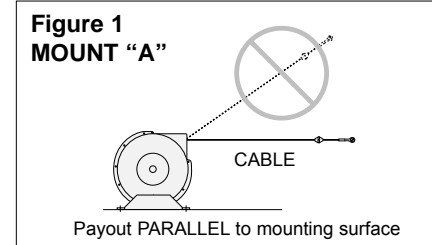

### TENSION ADJUSTMENT

**INCREASE TENSION** if reel will not completely wind cable so that cable stop reaches guide.

1. Allow cable to retract as far as possible.
2. Place wrench on flats of shaft. Turn shaft **counter-clockwise** until cable stop reaches guide.

**DECREASING TENSION** is NOT recommended and should not be necessary as the reel is shipped with minimum tension required to wind installed cable.

1. Place wrench on flats of shaft.
2. Hold shaft **firmly** with wrench. Depress spring on opposite side of reel.
3. Allow shaft to turn **SLOWLY** in **clockwise** direction until desired tension is achieved. If shaft will not turn in clockwise direction **UNASSISTED**, reel is at minimum tension and further tension reduction should not be attempted.

#### **DANGER**

DO NOT allow cable to retract in an uncontrolled manner. Always guide cable back to reel. Failure to do so can result in damage to reel or personal injury.

### SERVICE

#### REGULAR MAINTENANCE

1. Reel is factory lubricated for life. No additional lubrication is required.
2. Periodically check cable for wear. **If wear is detected, cable should be replaced immediately.** If cable replacement is required, order cable Assembly Kit No.5 which contains cable and related parts, hardware and instructions. See Parts List (inside) for details.

#### SPRING REPLACEMENT

#### **DANGER**

DO NOT attempt to remove spring motor from its canister. Doing so can result in damage to reel or personal injury.

Spring motors are self-contained for safe and easy handling. If spring motor replacement is required, it should be replaced as a unit by ordering Spring Motor Assembly Kit No. 1 which contains the spring motor, spool, shaft & bushings in a sealed canister. See Parts List (inside) for details.



**Workplace Solutions**

P.O. Box 26 • 600 South Clark St.  
Mayville, WI 53050  
Phone 920-387-4120

## RETRIEVER REEL ILLUSTRATED PARTS LIST

Replacement parts available as kits only.

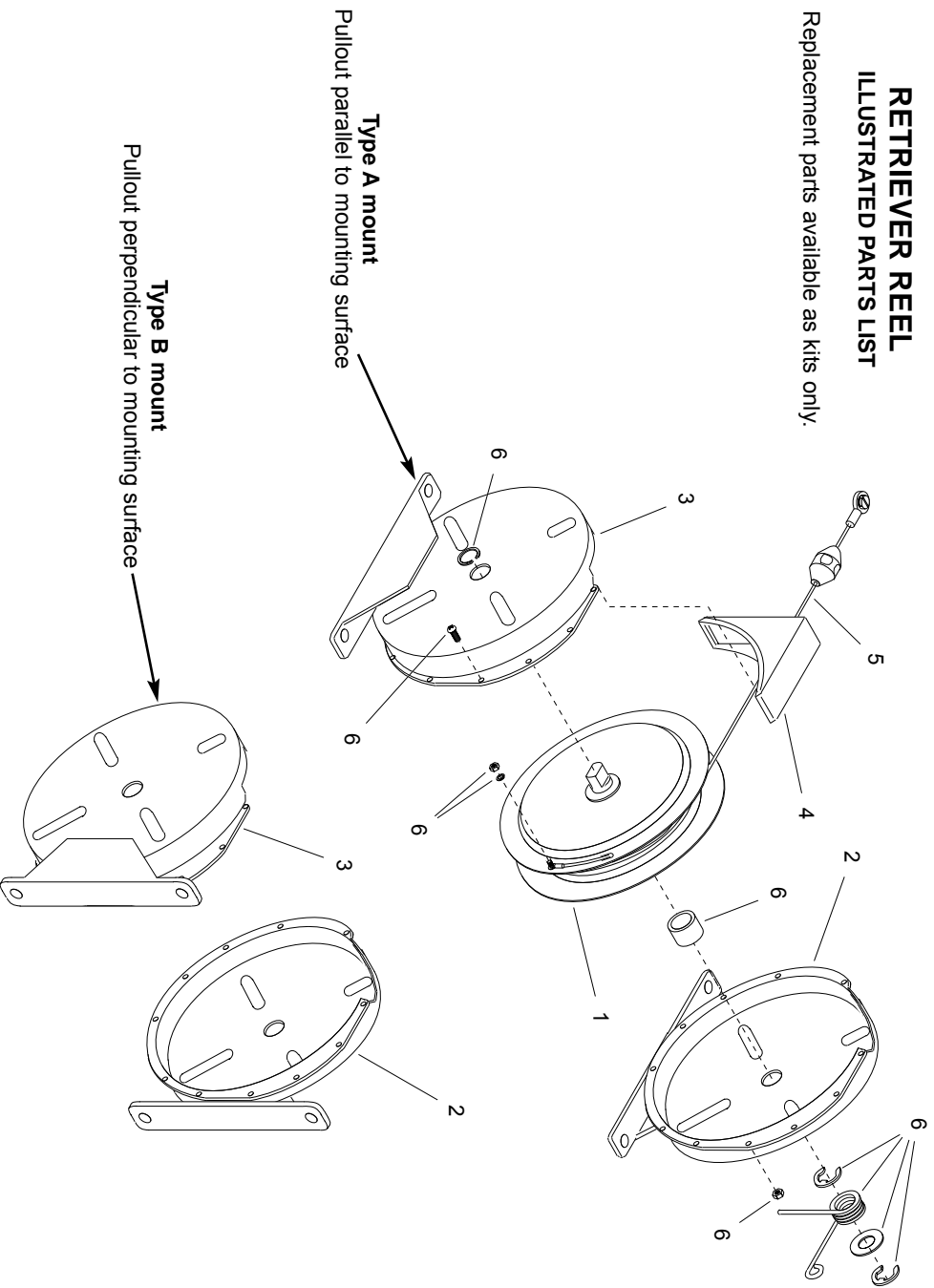

## RETRIEVER REEL

### REPLACEMENT PARTS KITS

REFERENCE NUMBER	KIT NUMBER		KIT DESCRIPTION
	Mount "A"	Mount "B"	
1	TQR0850-K01	TQV0850-K01	<b>SPRING MOTOR ASS'Y:</b> Spring Motor, Spool, Shaft & Bushings in sealed canister. Specify model number of your reel.
	TQR1215-K01	TQV1215-K01	
	TQR1230-K01	TQV1230-K01	
	TQR2215-K01	TQV2215-K01	
2	TQR3008-K01	TQV3008-K01	<b>RH HOUSING ASS'Y:</b> RH Housing Half
	TQR-K02*	TQV-K02*	
3	TQR-K03*	TQV-K03*	<b>LH HOUSING ASS'Y:</b> LH Housing Half, Nameplate.
4	TQR-K04**		<b>CABLE GUIDE</b>
5	TQR0850-K05	TQV0850-K05	<b>CABLE ASS'Y:</b> Cable, Cable Stop, Eye. Specify model number of your reel.
	TQR1215-K05	TQV1215-K05	
	TQR1230-K05	TQV1230-K05	
	TQR2215-K05	TQV2215-K05	
	TQR3008-K05	TQV3008-K05	
6	TQR-K06**		<b>HARDWARE PACKAGE:</b> Spacer, Torsion Spring, Pan Head Screw M4 x 10mm (8), Locknut M4 (8), #8-32 Hex Nut, #8 Int. Tooth Lock Washer, Retaining Ring (3).

\* Common to all cable lengths and spring configurations.

\*\* Common to all models.